

43' 10"

2D OVERALL

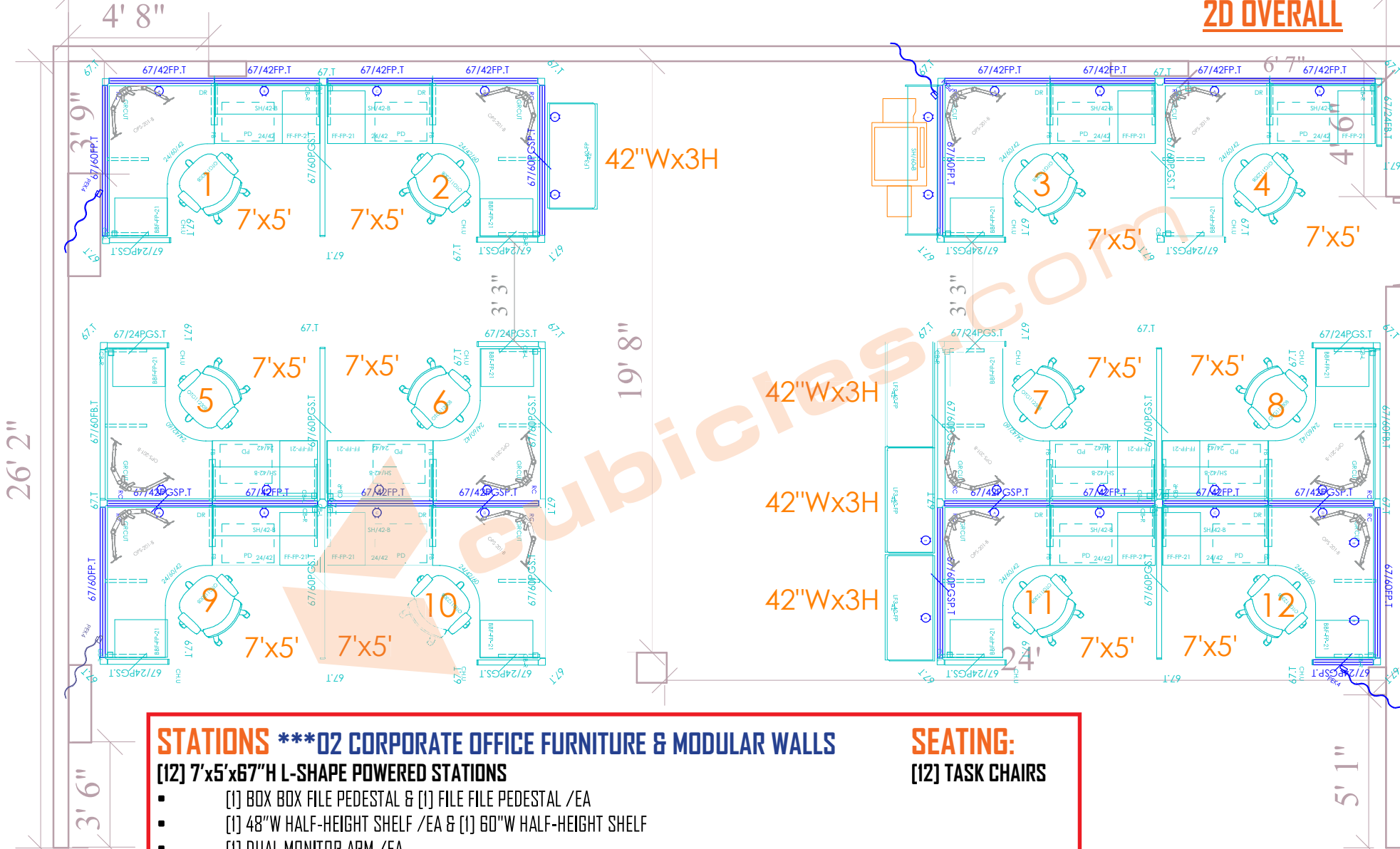

STATIONS *O2 CORPORATE OFFICE FURNITURE & MODULAR WALLS**

[12] 7'x5'x67''H L-SHAPE POWERED STATIONS

- [1] BOX BOX FILE PEDESTAL & [1] FILE FILE PEDESTAL /EA
- [1] 48''W HALF-HEIGHT SHELF /EA & [1] 60''W HALF-HEIGHT SHELF
- [1] DUAL MONITOR ARM /EA
- [1] PENCIL DRAWER /EA
- [1] METAL COAT HOOK /EA
- [4] 42''W 3-DRAWER LATERAL FILE W/ LAMINATE TOP.

SEATING:

[12] TASK CHAIRS

POWERED ELEMENTS
NON-POWERED COMPONENTS